



CXT® Precast Concrete Products manufactures restroom, shower and concession buildings in multiple designs, textures and colors. The roof and walls are fabricated with high strength precast concrete to meet all local building codes and textured to match local architectural details. All CXT buildings are designed to meet A.D.A. and to withstand heavy snow, high wind and category E seismic loads. All concrete construction also makes the buildings easy to maintain and withstand the rigors of vandalism. The buildings are prefabricated and delivered complete and ready-to-use, including plumbing and electrical where applicable. With thousands of satisfied customers nationwide, CXT is the leader in prefabricated concrete restrooms.

1. ORDERING ADDRESS(ES): CXT Precast Concrete Products, 606 N. Pines Road, Suite 202, Spokane Valley, WA 99206

2. ORDERING PROCEDURES: Fax 509-928-8270

3. PAYMENT ADDRESS(ES):

Remitting by check:

CXT, Inc., PO Box 643343, Pittsburgh, PA 15264-3343

Remitting by ACH or wire transfer:

Beneficiary: CXT, Inc.

Beneficiary Bank: PNC Bank, Pittsburgh, PA

Account: 1019282233 ABA/Routing: 043000096

Email remittance details to AR@lbfooster.com

4. WARRANTY PROVISIONS: CXT provides a one (1) year warranty. The warranty is valid only when concrete is used within the specified loadings. Furthermore, said warranty includes only the related material necessary for the construction and fabrication of said concrete components. All other non-concrete components will carry a one (1) year warranty. CXT warrants that all goods sold pursuant hereto will, when delivered, conform to specifications set forth above. Goods shall be deemed accepted and meeting specifications unless notice identifying the nature of any non-conformity is provided to CXT in writing within the specified warranty. CXT, at its option, will repair or replace the goods or issue credit for the customer provided CXT is first given the opportunity to inspect such goods. It is specifically understood that CXT's obligation hereunder is for credit, repair or replacement only, F.O.B. CXT's manufacturing plants, and does not include shipping, handling, installation or other incidental or consequential costs unless otherwise agreed to in writing by CXT.

This warranty shall not apply to:

1. Any goods which have been repaired or altered without CXT's express written consent, in such a way as in the reasonable judgment of CXT, to adversely affect the stability or reliability thereof;

2. To any goods which have been subject to misuse, negligence, acts of God or accidents; or

3. To any goods which have not been installed to manufacturer's specifications and guidelines, improperly maintained, or used outside of the specifications for which such goods were designed.

5. TERMS AND CONDITIONS OF INSTALLATION (IF APPLICABLE): All prices subject to the "Conditions of Sale" listed on the CXT quotation form.

Customers are responsible for marking exact location building is to be set; providing clear and level site, free of overhead and/or underground obstructions; and providing site accessible to normal highway trucks and sufficient area for the crane to install and other equipment to perform the contract requirements. Customer shall provide notice in writing of low bridges, roadway width or grade, unimproved roads or any other possible obstacles to access. CXT reserves the right to charge the customer for additional costs incurred for special equipment required to perform

delivery and installation. Customers will negotiate installation on a project-by-project basis, which shall be priced as separate line items. For more information regarding installation and truck turning radius guidelines please see our website at <http://www.cxtinc.com>.

In the event delivery of the building/s ordered is/are not completed within 30 days of the agreed to schedule through no fault of CXT, an invoice for the full contract value (excluding shipping and installation costs) will be submitted for payment. Delivery and installation charges will be invoiced at the time of delivery and installation.

Should the delivery and installation costs increase due to changes in the delivery period, this increase will be added to the price originally quoted, and will be subject to the contract payment terms.

In the event that the delivery is delayed more than 90 days after the agreed to schedule and through no fault of CXT, then in addition to the remedies above, a storage fee of 1-1/2% of contract price per month or any part of any month will be charged.

****Customer is responsible for all local permits and fees.**

6. DELIVERY CHARGE: All prices F.O.B. origin prepaid and added to invoice. CXT operates three (3) manufacturing plants in the United States and will deliver from the closest location on our carriers.

7. PAYMENT TERMS: Payment to CXT by the purchaser shall be made net 30 days after submission of the invoice to the purchaser on approved credit. Interest at a rate equal to the lower of (i) the highest rate permitted by law; or (ii) 1.5% per month will be charged monthly on all unpaid invoices beginning with the 35th day (includes five (5) day grace period) from the date of the invoice. Under no circumstance can retention be taken. If CXT initiates legal proceeding to collect any unpaid amount, purchaser shall be liable for all of CXT's costs, expenses and attorneys' fees and costs of any appeal.

8. LIMITATION OF REMEDIES: ~~In the event of any breach of any obligations hereunder, breach of any warranty regarding the goods, or any negligent act or omission of any party, the parties agree to submit all claims to binding arbitration.~~ ^{RCV} Any settlement reached shall include all reasonable costs including attorney fees. In no event shall CXT be subject to or liable for any incidental or consequential damages. Without limitation on the foregoing, in no event shall CXT be liable for damages in excess of the purchase price of the goods herein offered.

9. DELIVERY INFORMATION: All prices F.O.B. origin prepaid and added to invoice. CXT operates three (3) manufacturing plants in the United States and will deliver from the closest location on our carriers. Use the information below to determine the origin:

- F.O.B. 6701 E. Flamingo Avenue, Building 300, Nampa, ID 83687 applies to: AK, CA, HI, ID, MT, ND, NV, OR, SD, UT, WA, WY.

- F.O.B. 901 North Highway 77, Hillsboro, TX 76645 applies to AR, AZ, CO, IA, KS, LA, MN, MO, MS, NE, NM, OK, TX.

- F.O.B. 362 Waverly Road, Williamstown, WV 26183 applies to AL, CT, DE, FL, GA, IL, IN, KY, MA, MD, ME, MI, NC, NH, NJ, NY, OH, PA, PR, RI, SC, TN, VA, VT, WI, WV.

- Prices exclude all federal/state/local taxes. Tax will be charged where applicable if customer is unable to provide proof of exemption.

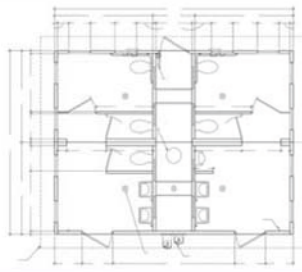

Taos with chase restroom building. Standard features include simulated barnwood texture walls, simulated cedar shake textured roof, vitreous china fixtures, 30-gallon water heater, interior and exterior lights, off loaded, and set up at site.

Base Price	Price per unit	Click to select	
Taos 20' x 26'	\$ 120,268.00		120,268.00

Added Cost Options:

Final Connection to Utilities		\$ 3,500.00	<input checked="" type="checkbox"/>	3,500.00
Optional Wall Texture -choose one	<input type="radio"/> Split Face Block (\$3,500) <input type="radio"/> Struck Trowel (\$3,500) <input checked="" type="radio"/> Stone (\$5,000)		Reset Wall Texture	10,000.00
Optional Roof Texture -choose one	<input checked="" type="checkbox"/> Delta Rib	\$ 3,000.00		6,000.00
Insulation/Heaters (per section)	Qty: 2	\$ 18,500.00	<input type="checkbox"/>	0.00
Vitreous Urinal (each)	Qty: 1	\$ 300.00	<input type="checkbox"/>	0.00
Stainless Steel Water Closet (each)	Qty: 5	\$ 950.00	<input checked="" type="checkbox"/>	4,750.00
Stainless Steel Lavatory (each)	Qty: 4	\$ 600.00	<input checked="" type="checkbox"/>	2,400.00
Stainless Steel Urinal (each)	Qty: 1	\$ 950.00	<input checked="" type="checkbox"/>	950.00
Electric Hand Dryers (each)	Qty: 2	\$ 700.00	<input checked="" type="checkbox"/>	1,400.00
Electronic Flush Valves (each)	Qty: 5	\$ 750.00	<input type="checkbox"/>	0.00
Electronic Lavatory Faucets (each)	Qty: 4	\$ 650.00	<input type="checkbox"/>	0.00
Electronic Urinal Valve (each)	Qty: 1	\$ 750.00	<input type="checkbox"/>	0.00
Exterior Mounted ADA Drinking Fountain w/Cane Skirt	Qty: 1	\$ 3,600.00	<input checked="" type="checkbox"/>	3,600.00
Optional Door Closure (each)	Qty: 2	\$ 450.00	<input type="checkbox"/>	0.00
Skylight in Restroom (each)	Qty: 4	\$ 450.00	<input type="checkbox"/>	0.00
Marine Grade Skylight in Restroom (each)	Qty: 4	\$ 1,600.00	<input type="checkbox"/>	0.00
Marine Package for Extra Corrosion Resistance (per section)	Qty: 2	\$ 3,450.00	<input type="checkbox"/>	0.00
Tile Floor in Restroom (per section)	Qty: 2	\$ 3,000.00	<input type="checkbox"/>	0.00
Fiberglass Entry and Chase Doors and Frames	Qty: 3	\$ 1,700.00	<input type="checkbox"/>	0.00
2K Anti-Graffiti Coating (per section)	Qty: 2	\$ 3,500.00	<input type="checkbox"/>	0.00
Timed Electric Lock System (2 doors - does not include chase door)	Qty: 1	\$ 2,500.00	<input checked="" type="checkbox"/>	2,500.00
Exterior Frostproof Hose Bib with Box (each)	Qty: 1	\$ 450.00	<input checked="" type="checkbox"/>	450.00
Paper Towel Dispenser (each)	Qty: 2	\$ 200.00	<input type="checkbox"/>	0.00
Toilet Seat Cover Dispenser (each)	Qty: 5	\$ 100.00	<input type="checkbox"/>	0.00
Sanitary Napkin Disposal (each)	Qty: 3	\$ 75.00	<input checked="" type="checkbox"/>	225.00
Baby Changing Station (each)	Qty: 2	\$ 500.00	<input type="checkbox"/>	0.00
CXT Wastebasket (each)	Qty: 2	\$ 150.00	<input checked="" type="checkbox"/>	300.00

Total Cost of Selected Accessories from Accessories Price List: \$ 36,075.00

Engineering and State Fees: 3,400.00

Estimated One-Way Transportation Costs to Site (quote): \$ 11,800.00

Custom Options: XtraCrane-(3,000), TrilogyLockSystem(battery oper.)(2,500), '22 price add(31,768.60 - 5,000=26,768.60) \$ 32,268.60

Total Cost per Unit Placed at Job Site: (excludes all taxes) \$ 203,811.60

Estimated monthly payment on 5 year lease \$4,096.61

This price quote is good for 60 days from date below, and is accurate and complete.

Robert C. Veals, Jr. expires Feb. 18, 2022
CXT Sales Representative

Date



I accept this quote. Please process this order.

Company Name

Customer

Date

OPTIONS

Exterior Color Options:

(For single color mark an X or for two tone combinations use W = Walls / R = Roof.)

<input type="checkbox"/>	Amber Rose	<input type="checkbox"/>	Liberty Tan	<input type="checkbox"/>	Berry Mauve	<input type="checkbox"/>	Sage Green
<input type="checkbox"/>	Toasted Almond	<input type="checkbox"/>	Oatmeal Buff	<input type="checkbox"/>	Buckskin	<input type="checkbox"/>	Rosewood
<input type="checkbox"/>	Sun Bronze	<input type="checkbox"/>	Golden Beige	<input type="checkbox"/>	Mocha Carmel	<input type="checkbox"/>	Malibu Taupe
<input type="checkbox"/>	Sand Beige	<input type="checkbox"/>	Natural Honey	<input type="checkbox"/>	Salsa Red	<input type="checkbox"/>	Java Brown
<input type="checkbox"/>	Pueblo Gold	<input type="checkbox"/>	Cappuccino Cream	<input type="checkbox"/>	Coca Milk	<input type="checkbox"/>	Raven Black
<input type="checkbox"/>	W Granite Rock	<input type="checkbox"/>	Georgia Brick	<input type="checkbox"/>	Western Wheat	<input type="checkbox"/>	Nuss Brown
<input type="checkbox"/>	Rich Earth	<input type="checkbox"/>	R Charcoal Grey	<input type="checkbox"/>	Hunter Green	<input type="checkbox"/>	Evergreen

Special roof color # _____

Special wall color # _____

Special trim color # _____

(Sage green, hunter and evergreen colors are not available in colored through concrete.)

Rock Color Options:

Basalt Mountain Blend Natural Grey Romana

Roof Texture Options:

Cedar Shake Ribbed Metal

Wall Texture Options:

(For single texture mark an X or for different top and bottom textures use T = Top / B = Bottom.)

Barnwood	Horizontal Lap	} Can only be used as bottom texture.
Split Face Block	T Board & Batt	
Stucco/Skip Trowel	Brick	
		B Napa Valley Rock
		River Rock
		Flagstone

(Textures not included in CXT's quote are additional cost.)

Door Opener Options:

Non-locking ADA Handle Pull Handle/Push Plate
 Privacy ADA Latch

Deadbolt Options:

CXT Supplied Customer Supplied: _____
Type & Part Number

Accessible Signage Options:

Men Women Unisex

Paper Holder Options:

2-Roll Stainless Steel 3-Roll Stainless Steel

Notes: