



ACCEPTANCE OF 14.42 ACRES FOR PARKLAND DEDICATION

RS-26-054

April 21, 2026

Background

- On August 9, 2022, the City Council approved an ordinance to rezone approximately 390.72 acres from Agricultural District to a Planned Unit Development (PUD), known as Preserve at Thousand Oaks. The developer is proposing to dedicate 14.42 acres of parkland with Phase 2 of the development.

Background

- The proposed parkland aligns with the Killeen Parks and Open Space Master Plan, specifically recommendation PS4, which aims to identify properties and develop two additional community parks in southern areas of the City as growth continues. Additionally, it meets the parkland dedication and development recommendations, as well as the linear park and trail growth objectives outlined in the Master Plan.

Background

- The 14.42 acres of parkland dedication will include a playground, pavilion, picnic tables, a parking lot, open space, and an 8-foot-wide concrete trail installed by the developer. The development also includes plans for additional parkland, that will come to council for acceptance for subsequent phases of development.

5

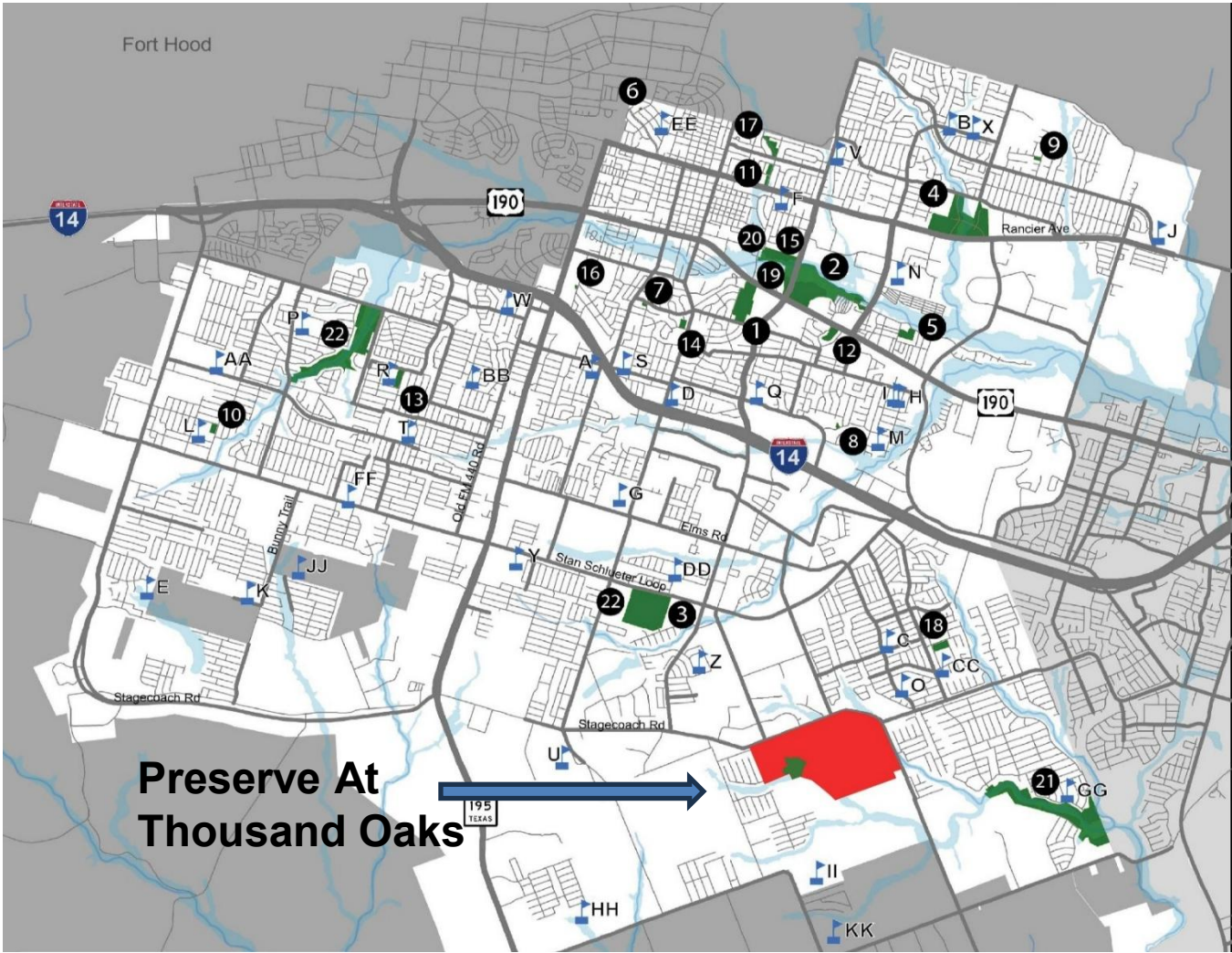

Parkland Area 14.42 acre (Phase 2)

BOWFIELD DR.

STAGECOACH RD

STAGECOACH RD

STAGECOACH RD

SITE AMENITIES

-  PLAYGROUND AND COMMUNITY PARK (1)
-  DOG PARK (2)
-  5' WIDE CONCRETE TRAIL (+/- .3 MILES)
-  8' WIDE CONCRETE TRAIL (+/- 2.5 MILES)
-  FISHING POND (1)
-  PICNIC PAVILIONS (3)
-  6' PARK BENCH ALONG 8' TRAIL (1 PER .25 MILE)
-  DRINKING FOUNTAIN (3)
-  PARK / TRAIL LIGHTING (EXACT COUNT TBD)



Cut the Camera Podcast

FISHING POND

DOG PARK

OPEN SPACE









OPEN SPACE

OPEN SPACE

PRESERVE
AT THOUSAND OAKS



SITE AMENITIES

-  PLAYGROUND AND COMMUNITY PARK (1)
-  DOG PARK (2)
-  5' WIDE CONCRETE TRAIL (+/- .3 MILES)
-  8' WIDE CONCRETE TRAIL (+/- 2.5 MILES)
-  FISHING POND (1)
-  PICNIC PAVILIONS (3)
-  6' PARK BENCH ALONG 8' TRAIL (1 PER .25 MILE)
-  DRINKING FOUNTAIN (3)
-  PARK / TRAIL LIGHTING (EXACT COUNT TBD)



8



9



10





12



13



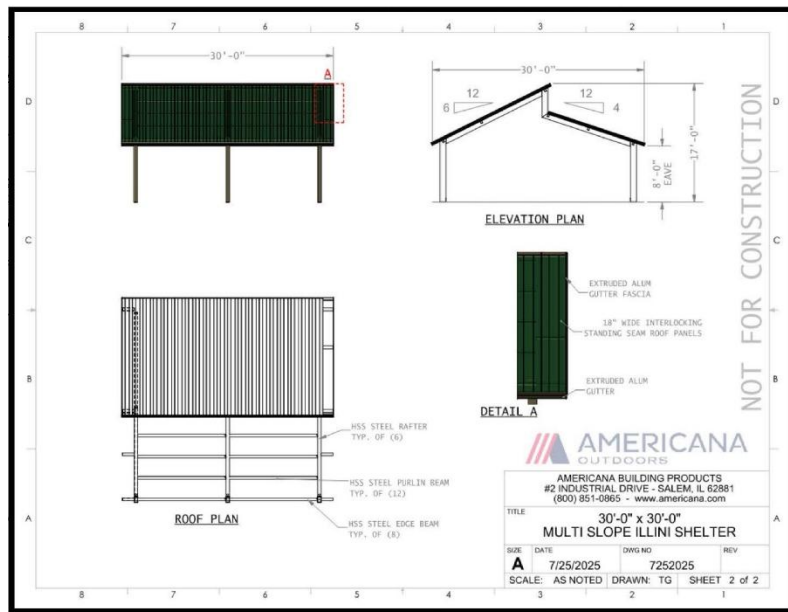

14

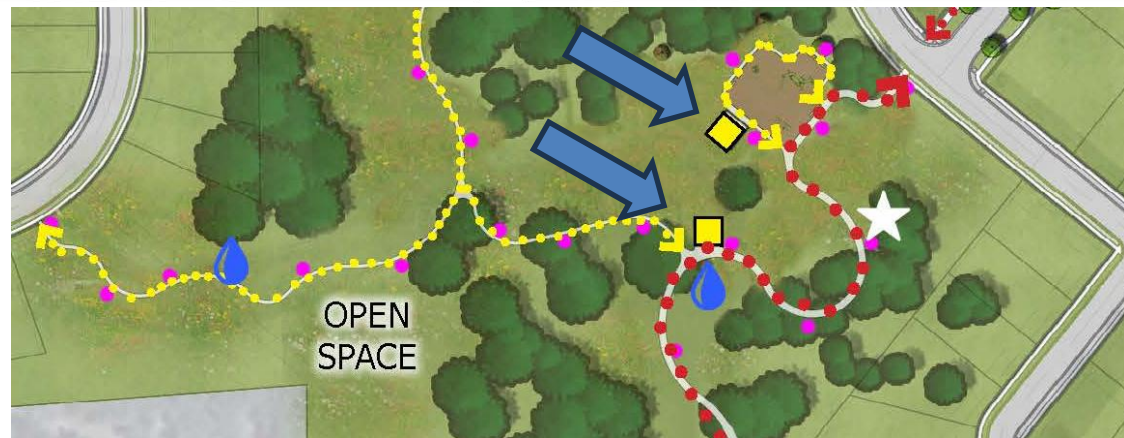

Maintenance Cost Projections

15

- The developer has paid for/installed the playground and other park amenities.
- HOA would maintain the area under a future MOA with an estimated annual cost to City of \$35,000
- Funds will be available in the Parks Professional Services account after budget transfers are completed from the relevant Parks operational accounts.

Recommendation

- Staff recommends that Council approve the acceptance of 14.42 acres of Parkland dedication for Preserve at Thousand Oaks Phase 2.