

**Deed Sketch for a tract of land in Bell County, Texas, being part of the J Cook Survey,  
Abstract No. 161, Official Public Records of Real Property, Bell County, Texas**

**FUTURE LAND USE EXHIBIT**

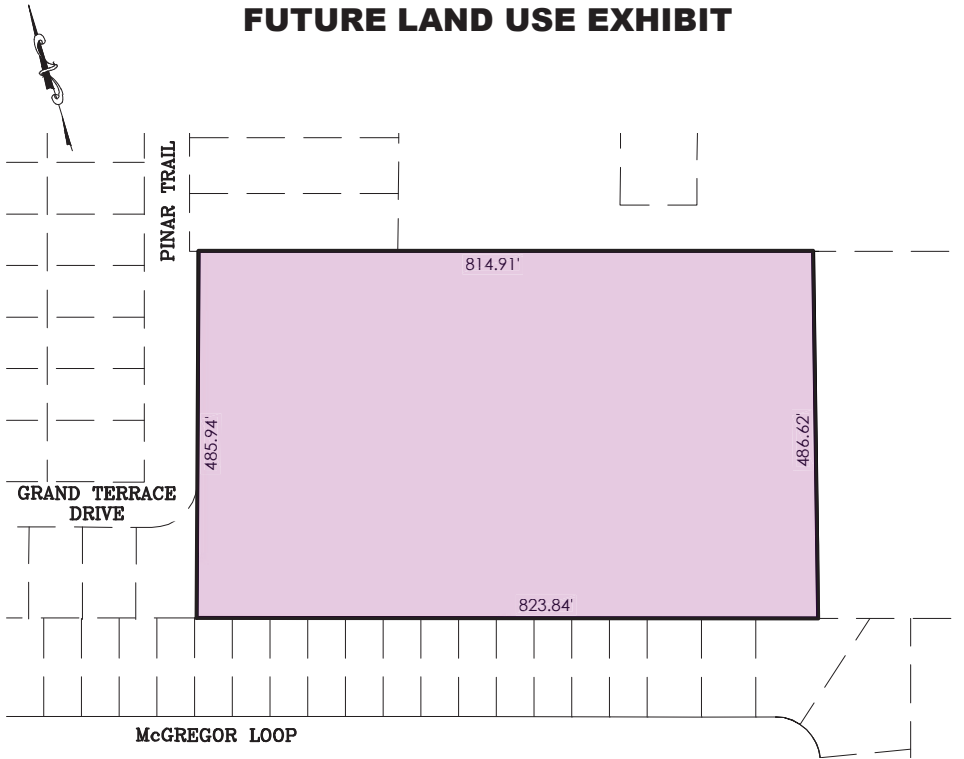

DRAWN BY: FRB

1:11 PM

S:\SUBDIVISIONS\21-079-D-S (9 Ac. Clear Creek)\dwg\Rezone & FLUM AG to RT1\21-079-D-S Clear Creek Incom RT1 FLUM.dwg 9/23/2021

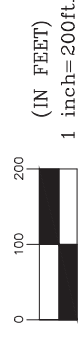

 Future Land Use:  
General Residential (GR)

**NOTE:**

The above drawing does not represent an on the ground survey. Sketch has been drawn based on existing recording information.

102 N. COLLEGE ST., KILLEEN, TEXAS (254) 634-5541  
T. B. P. L. S. FIRM REGISTRATION NO. 10020000  
411 S. WESTERN AVE. (P.O. BOX 349), LAMPASAS, TEXAS (512) 556-6885  
T. B. P. L. S. FIRM REGISTRATION NO. 100204-00  
600 AUSTIN AVE. STE. 29, WACO, TEXAS (254) 776-5151  
T. B. P. L. S. FIRM REGISTRATION NO. 10194044

**MITCHELL & ASSOCIATES, INC.**  
ENGINEERING & SURVEYING



ALL RIGHTS RESERVED  
BY: MITCHELL & ASSOC., INC. 2021