

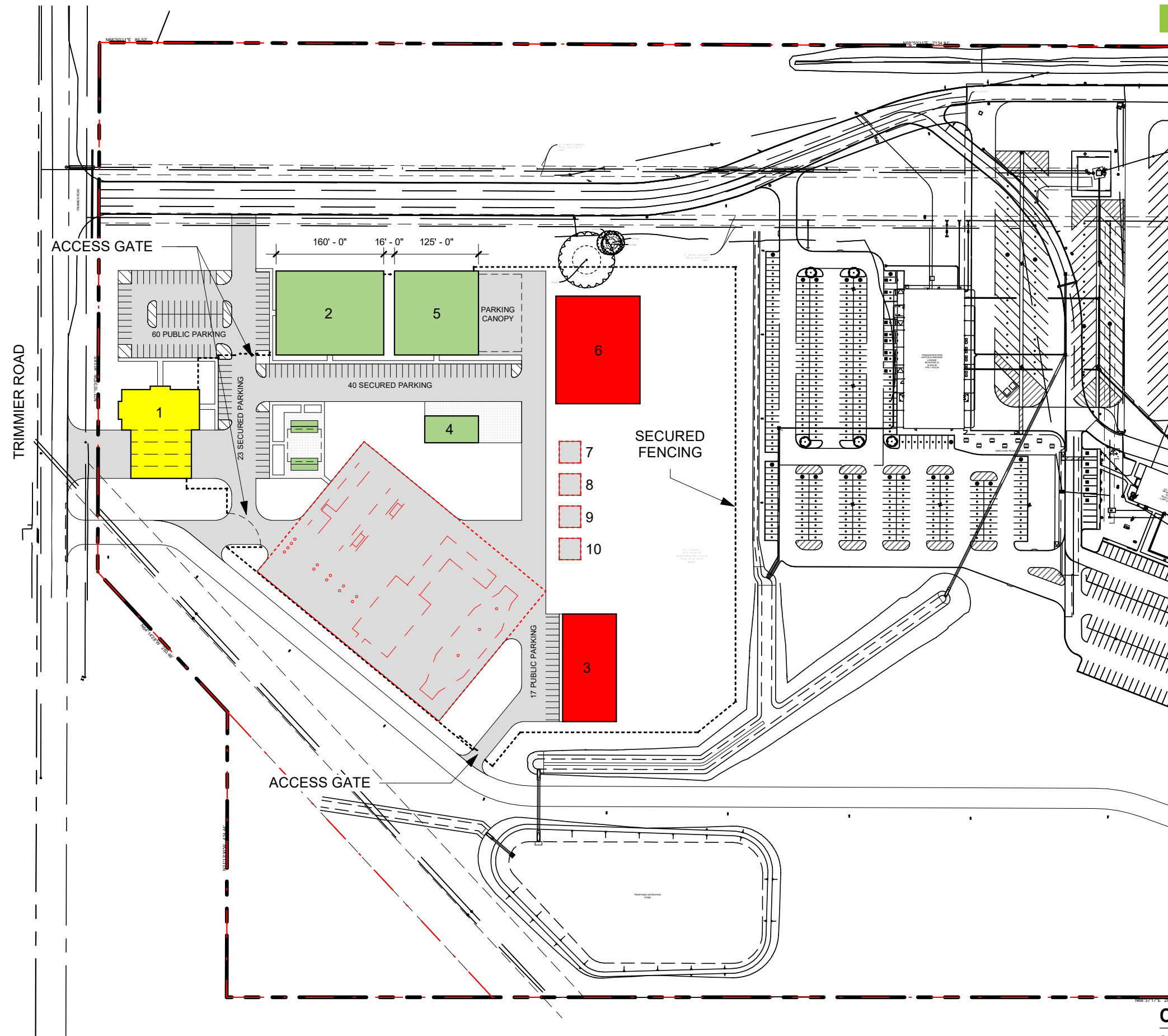

KILLEEN FIRE DEPARTMENT TRAINING CAMPUS



- | | |
|---|-----------|
| 1. FIRE STATION | 12,000 SF |
| 2. EOC / TRAINING BUILDING | 16,000 SF |
| 3. POLICE/FIRE SHARED TACTICAL TRAINING | 12,800 SF |
| 4. CLASS "A" / "B" BURN BUILDING | |
| 5. SUPPORT/MAINTENANCE | 12,600 SF |
| 6. FUTURE TRAINING/SUPPORT EXPANSION | |
| 7. CAR FIRE PROP | |
| 8. DUMPSTER FIRE PROP | |
| 9. TREE PROP | |
| 10. PROPANE TANK PROP | |

TOTAL PUBLIC PARKING 19 SPACES
TOTAL SECURED PARKING 60 SPACES

- PHASE I
PHASE II
PHASE III

OPTION 1

SCALE: 1" = 160'-0"

02/15/2022

