

SSK LODGING TRACT
KILLEEN, TEXAS

DATE: 05.11.23

A1.3

MASTER SITE
PLAN
Copyright © 2023

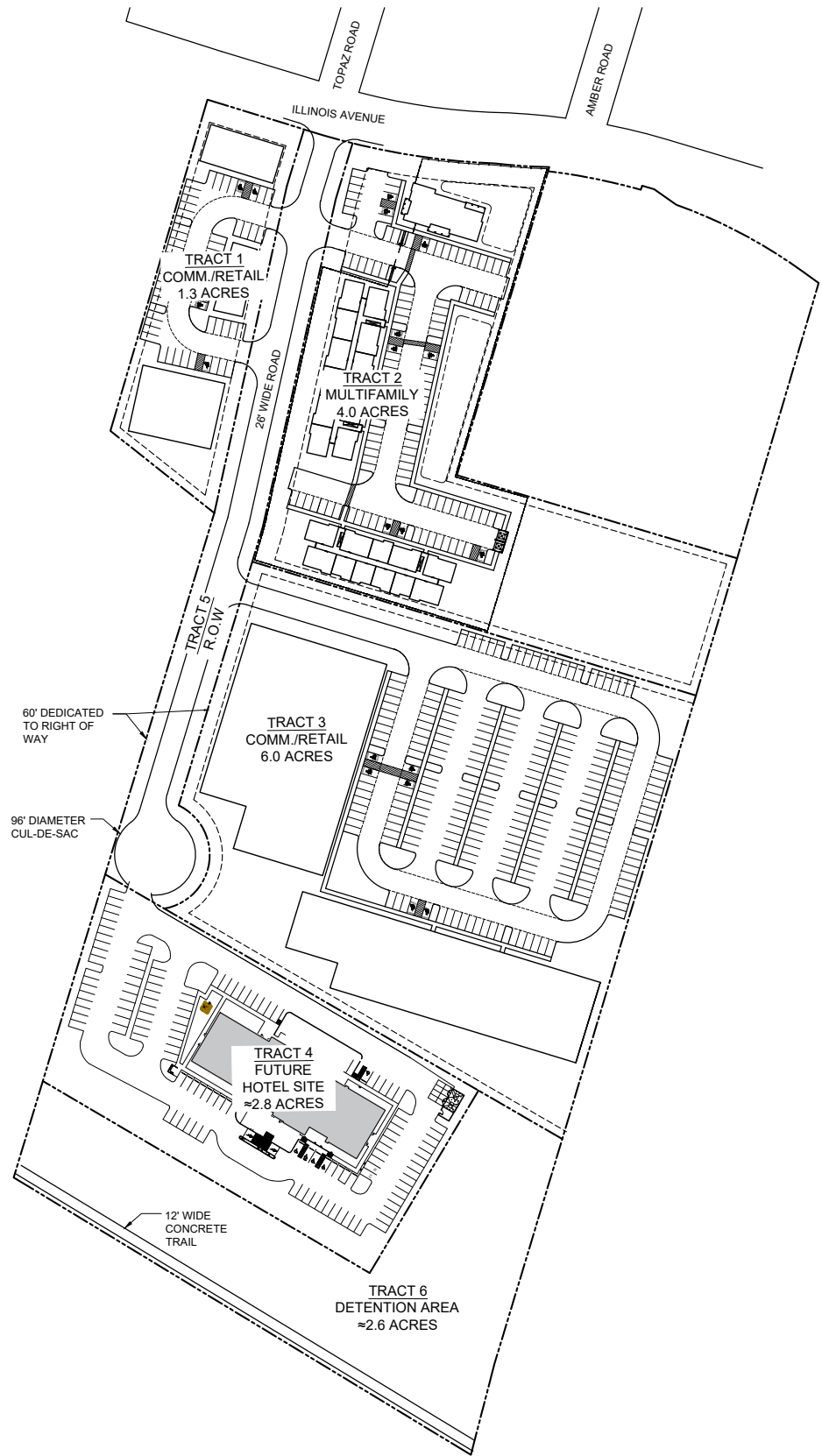

TRACT 1 (COMMERCIAL/RETAIL SITE #1)	
ACRES	1.3
(3) 1 STORY BUILDINGS	15,000 S.F.
ZONING	B-5

TRACT 2 (MULTIFAMILY)	
ACRES	4.0
(2) 3 STORY BUILDINGS	
TOTAL UNITS	69
UNITS/ACRE	17.25
PROPOSED ZONING	R-3A

TRACT 3 (COMMERCIAL/RETAIL SITE #2)	
ACRES	6.00
(3) 1 STORY BUILDINGS	75,000 S.F.
ZONING	B-5

TRACT 4 (FUTURE HOTEL)	
ACRES (TOTAL)	5.4
ACRES (BUILDABLE)	2.8
(1) 3 STORY BUILDING	16,156 S.F.
TOTAL ROOMS	105

TRACT 5 (FUTURE RIGHT-OF-WAY)	
ACRES	1.4
WIDTH	60 FEET
ROADWAY	26 FEET
CUL-DE-SAC	96 FEET DIAMETER

TRACT 6 (DETENTION AREA)	
ACRES	2.6



- MASTER SITE PLAN

