



# KCCC CARPET REPLACEMENT

RS-23-198

December 5 , 2023

# Background

2

- The carpet currently installed at the Killeen Civic and Conference Center (KCCC) is not rated for high traffic impact. After only 8 years, the carpet is showing excessive stains, wear and tear across the entire facility. Stains are embedded and do not come out, even with professional steaming.
- Flooring needs to be replaced to bring the building up to the standards required by the type of customers we currently attract, and we anticipate attracting.
- The current carpeting is becoming a safety issue with several pulls and tears occurring.

# Background (cont'd)

3

- On July 3, 2023, KCCC received one quote from a vendor on TIPS in the amount of \$263,392.05 and another quote in the amount of \$361,994.69.
- The higher quote was from a vendor not affiliated with TIPS-USA. Additionally, the price difference between the quotes was \$98,602.64.
- Due to the significant price difference, KCCC staff decided to move forward with McCoy Rockford and reseller of J&J and EF Contract Engineered Floor LLC.

# TIPS Contract

4

- ❑ McCoy Rockford and reseller of J&J and EF Contract Engineered Floor LLC conforms to city policy based on their TIPS Contract. The purchase will utilize TIPS cooperative contract #20110201.
- ❑ Purchases made through a cooperative contract are exempt from the competitive bidding process as stated in the Texas Local Government Code (TLGC) section 271.102.

# Kinetex Advanced Flooring

5

- Kinetex is an advanced textile composite flooring that combines key attributes of soft-surface floor covering with the long-wearing performance.
- Durability: The reference service life (RSL) of Kinetex carpet tile is assumed to be 15 years. Given the RSL of the products under consideration, 4 replacements of the product are required to cover the Estimated service life (ESL) of the KCCC which is 75 years.
- Health: Kinetex minimizes air particulates that trigger allergies and cause infection.

# Kinetex Advanced Flooring (cont'd)

6

- ❑ Maintenance: Stain resistant and easily sanitized, so cleaning is fast and affordable.
- ❑ Safety: Kinetex is the only wall-to-wall textile floor covering certified as High-Traction by the National Floor Safety Institute. It creates one of the most slip-resistant flooring surfaces ever tested— wet or dry—to prevent falls before they happen.
- ❑ Sustainability: Contains 45% post consumer content. Each tile contains about 27 plastic water bottles.

# Life Cycle Cost

7

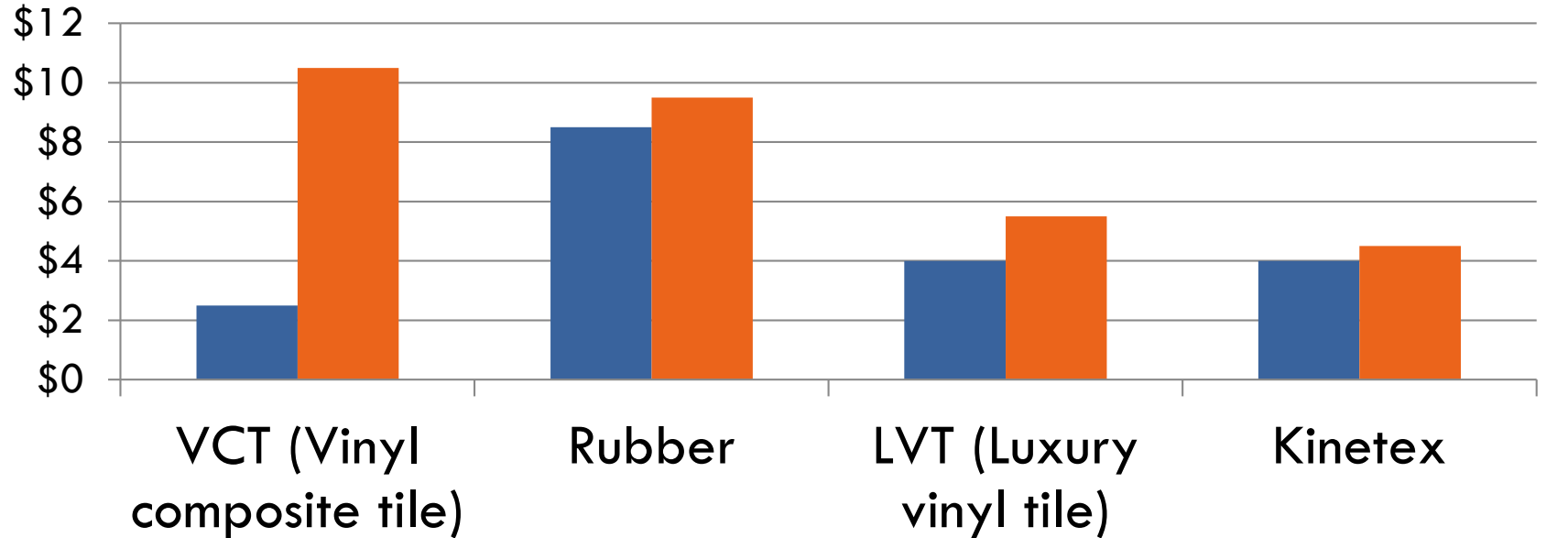

■ Installation & Materials cost/ sq.ft ■ 10 Years maintenance cost/sq.ft.



8

## Style, Color, Installation

2 different styles: Analog & Analog Mono

3 different colors each tile are quarter turns



# Killeen Civic Center Phasing Plan (cont'd)

9

- ❑ Phase 1 A&B – January 29-February 2
  - Ballroom A&B, Yellow Rose (1 & 2), & hallway.
- ❑ Phase 2 – February 17-23
  - Ballroom C
- ❑ Phase 3 – March 4-8
  - Chisholm Trail (3,4), Longhorn (5,6), & hallway.
- ❑ Phase 4 – March 11-15
  - Lone Star Room (Special Events Room)

# Killeen Civic Center Phasing Plan

10

## KILLEEN CONVENTION CENTER - PHASING

20 November 2023 : Killeen Convention Center-PHASING

### Summary Report



Scale 1:1110 (original drawing scale 1:192)

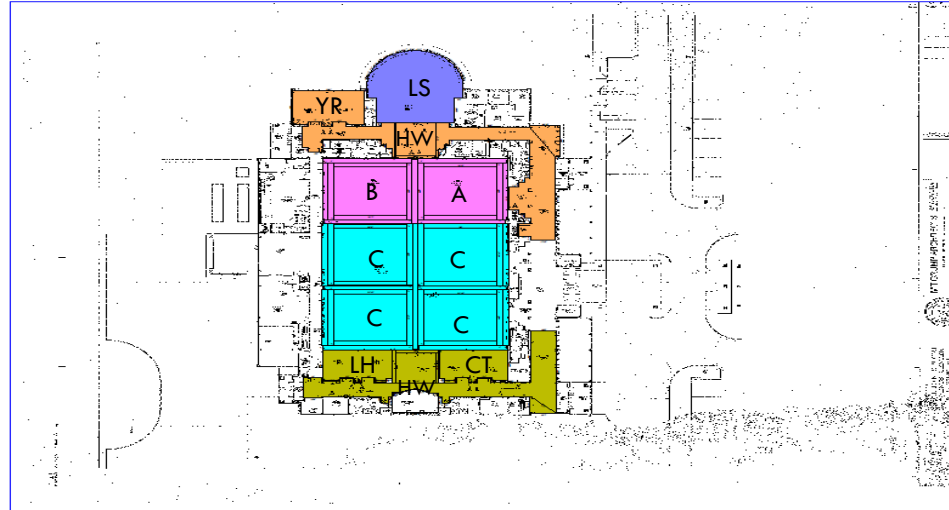

# Alternatives

11

- ❑ Do not approve the purchase of new carpeting.
- ❑ Approve the purchase of replacement carpet from another vendor.
- ❑ Approve the purchase of new carpet from McCoy Rockford and reseller of J&J and EF Contract Engineered Floor LLC, in the amount of \$263,392.05.

# Recommendation

12

Staff recommends awarding the purchase of new carpeting to McCoy Rockford and reseller of J&J and EF Contract Engineered Floor LLC in the amount of \$263,392.05.