



BELL COUNTY ANNEX – LOCATION OPTIONS

RS-22-034

April 5, 2022

First National Bank Texas

2



First National Bank Texas

3

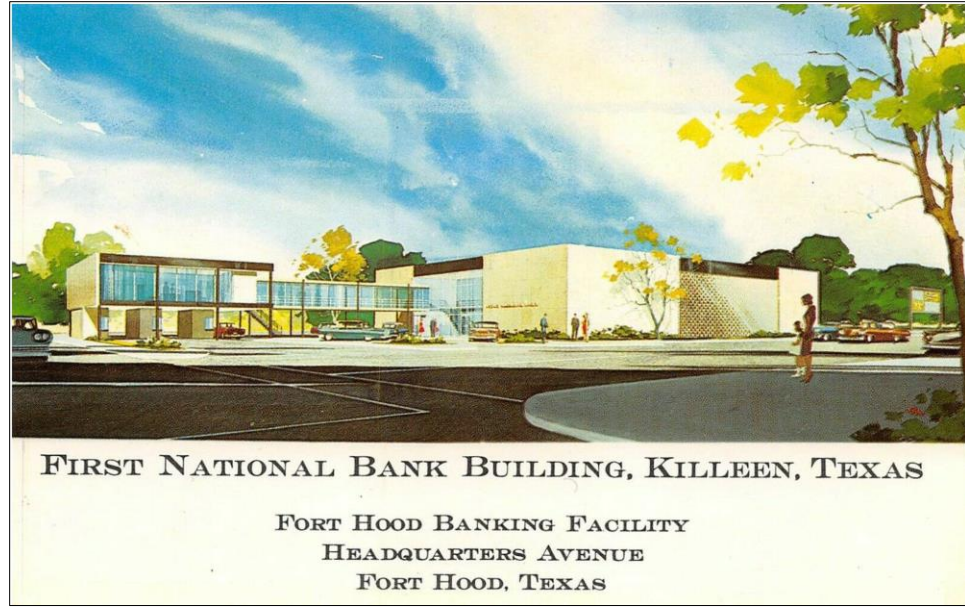

Options

□ **Option 1:**

Proceed with the Interlocal Agreement to demolish the First National Bank building, and Bell County will build a new County Annex building in its place.

□ **Option 2:**

Do not approve the Interlocal Agreement and donate land elsewhere downtown for an alternative County Annex location, such as the Police Station parking lot. The City of Killeen could then partner with a private developer to rehabilitate/redevelop the First National Bank building.

Option 1 – Bank Site

5

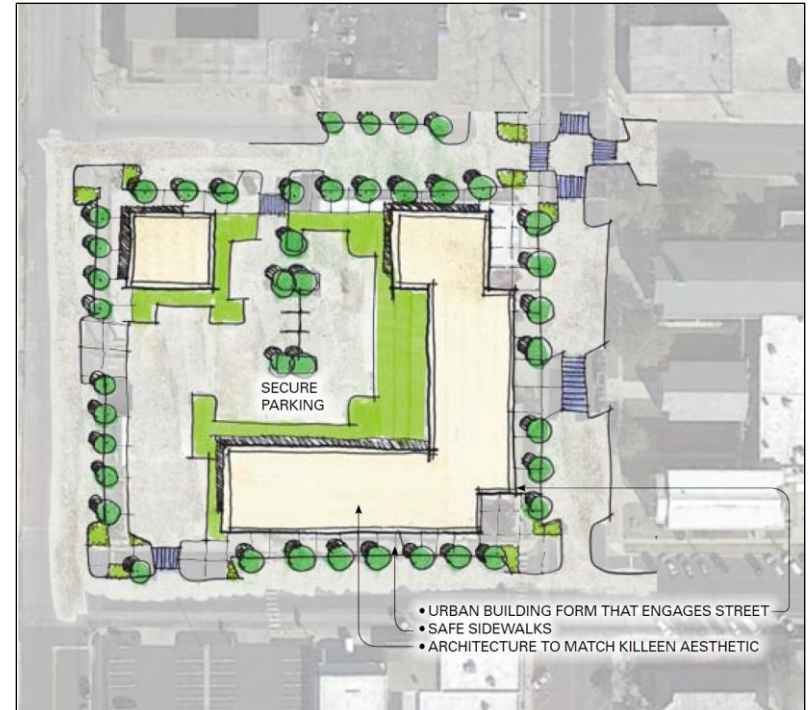

Steps to Demolish Bank

6

1. Review by Heritage Preservation Officer (HPO).
2. Review by Heritage Preservation Board (HPB).
3. Determination of economic hardship by HPB.
4. Appeal of HPB decision to City Council.

Option 2 – Police Station Site

7

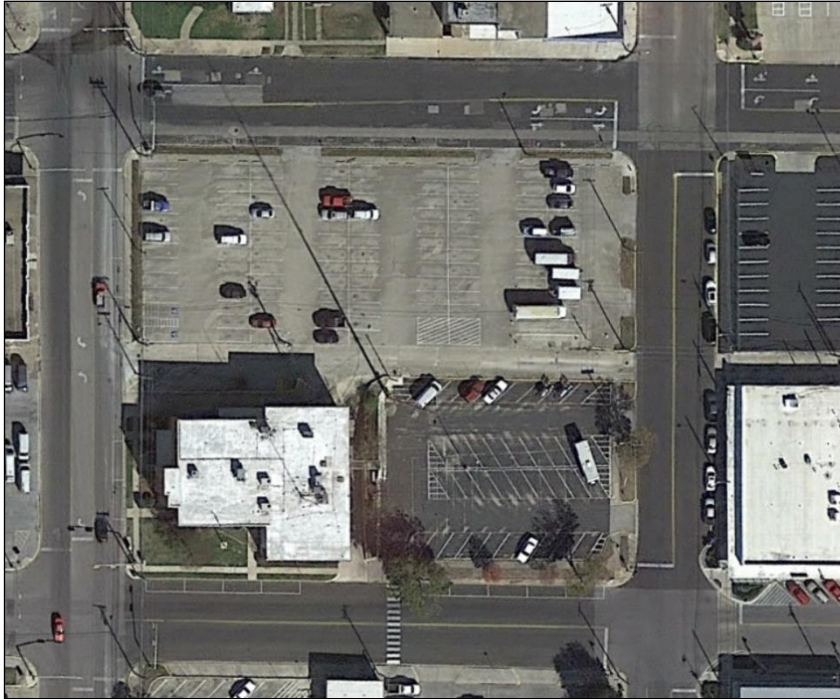

Option 2 – Future redevelopment of Bank Site

8

