



**PLANNING AND
DEVELOPMENT SERVICES**

ZONING CASE:

Z15-33

ZONING FROM:

R-1 To PUD

APPLICANT:

RSBP DEVELOPERS INC.







PROPERTY OWNER:

RSBP DEVELOPERS INC.

LEGAL DESCRIPTION:

BUNNY TRAIL ESTATES PH II -
BLK 11,12,13 LOT 3-34
BLK 10 LOT 1,2
BUNNY TRAIL ESTATES PH I -
BLK 10,11,12,13 LOT 1,2

LEGEND

-  200' Buffer
-  Zoning Case
-  Current Zoning
-  Subdivision
-  Parcel
-  City Limits



Date: 11/23/2015

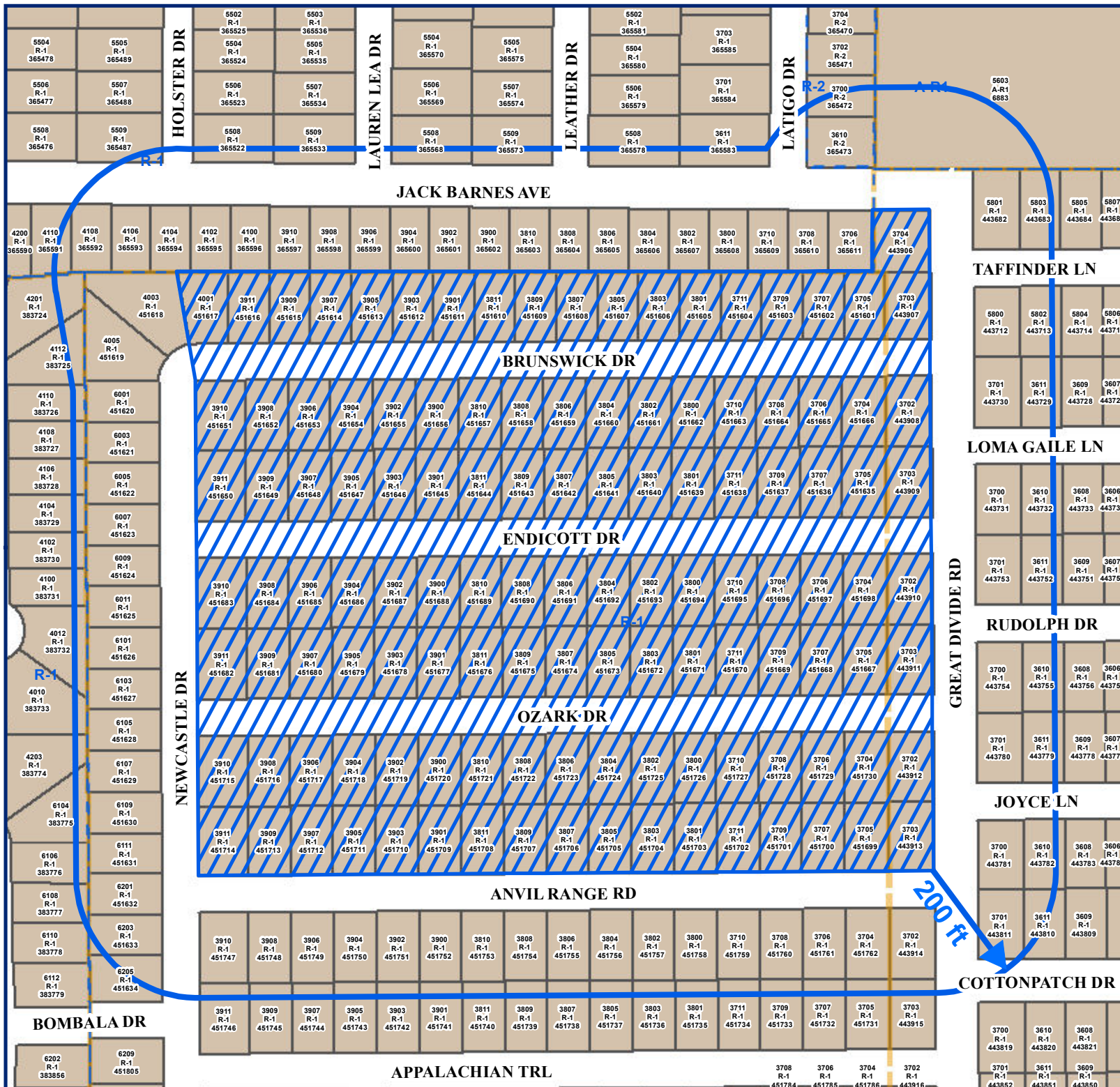

TAFFINDER LN

LOMA GAILE LN

RUDOLPH DR

JOYCE LN

COTTONPATCH DR

GREAT DIVIDE RD

200 ft

HOLSTER DR

LAUREN LEA DR

LEATHER DR

LATIGO DR

NEWCASTLE DR

BOMBALA DR

APPALACHIAN TRL